

Zaro HSK50 // Shaft $\varnothing 20$ mm // RS $\varnothing 50$ mm

Fitted to Zaro tool grinding machines with ring set $\varnothing 50$ mm

GWA HSK50 // $\varnothing 20$ mm // RS $\varnothing 50$ mm

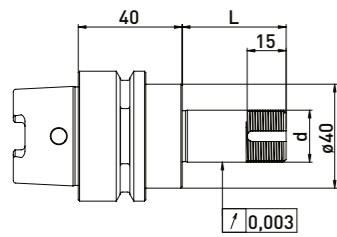
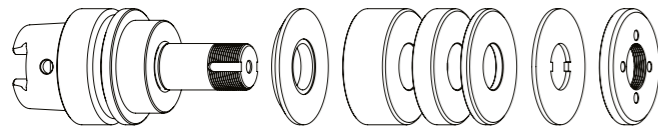

Delivered equipped:
Reducing washer, ring set $\varnothing 50$ mm, lock washer and clamping nut

Ring set $\varnothing 50$ mm

Order No.	HSK	d	L	B 20	B 10	B 4
300112012	HSK50	20	40	-	1	3
300112022	HSK50	20	60	1	1	3
300112032	HSK50	20	75	1	2	4
300112042	HSK50	20	85	2	1	4
300112052	HSK50	20	100	2	3	3

GWA HSK50 // $\varnothing 20$ mm // without RS

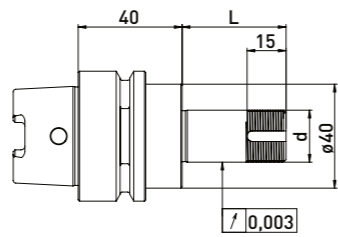
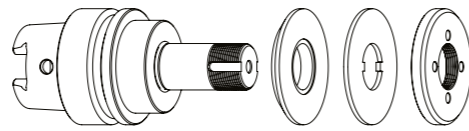

Delivered equipped:
Reducing washer, lock washer and clamping nut

Order No.	HSK	d	L
300112011	HSK50	20	40
300112021	HSK50	20	60
300112031	HSK50	20	75
300112041	HSK50	20	85
300112051	HSK50	20	100

Accessories Zaro grinding wheel adapter HSK50 // Shaft $\varnothing 20$ mm // Ring set $\varnothing 50$ mm

Order No.	Name
350050010	Universal assembly device $\varnothing 50$
350040010	*Clamping nut wrench PC27 for $\varnothing 20$
350040011	*Clamping nut wrench PC27 for $\varnothing 20$
350020021	*Balancing weight pair for clamping nut $\varnothing 50$ // 100gmm

Order No.	Name
350011020	Spacer ring $\varnothing 50 \times \varnothing 20 \times 20$
350011010	Spacer ring $\varnothing 50 \times \varnothing 20 \times 10$
350011004	Spacer ring $\varnothing 50 \times \varnothing 20 \times 4$
350015002	Reducing washer $\varnothing 40 \times \varnothing 50 \times \varnothing 20 \times 6$
350030010	Lock washer $\varnothing 50 \times \varnothing 20 \times 2$
350020060	Clamping nut $\varnothing 50 \times 6 \times M20 \times 1$ PC27
350020020	*Clamping nut with balancing option $\varnothing 50 \times 8,5$ M20 x 1,0 PC27

Adapters for dressing, presetting etc.

Adapter piece for tool grinding machines, dressing machines, presetting devices, balancing machines

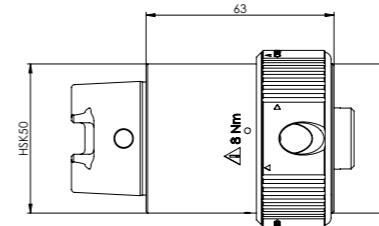

Order No.	Name
350130020	Adapter piece HSK50 on HSK40 A/C/E HSK50 B/D/F

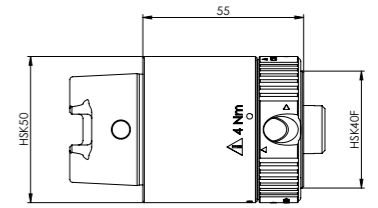

Order No.	Name
350130021	Adapter piece HSK50 on HSK32 A/C/E HSK40 B/D/F

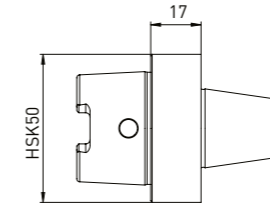

Order No.	Name
350130034	Adapter piece HSK50 on ANCA taper $\varnothing 30$

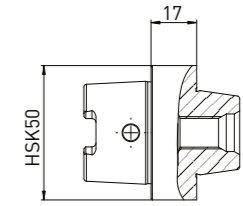

Order No.	Name
350130032	Adapter piece HSK50 on Haas/Walter taper

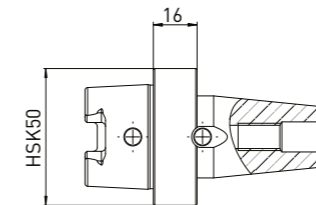

Order No.	Name
350130030	Adapter piece HSK50 on Strausak Fleximat

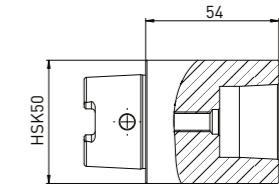

Order No.	Name
350130031	Adapter piece HSK50 on Strausak Promat

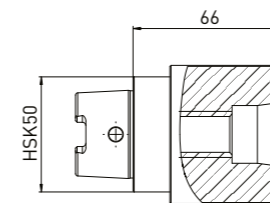

Order No.	Name
350130033	Adapter piece HSK50 on Saacke short taper

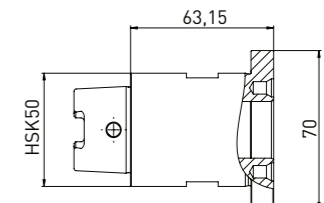

Order No.	Name
350130048	Adapter HSK50 x $\varnothing 25$ on Rollomatic

*related items

Adapters fine balanced SK40 and SK50 for tool grinding machines, dressing machines, presetting devices, balancing machines

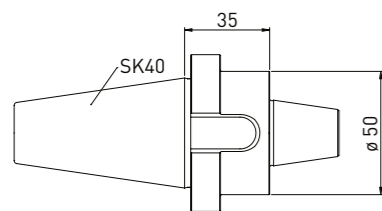

Order No.	Name
350130035	Adapter SK40 on ANCA taper $\varnothing 30$

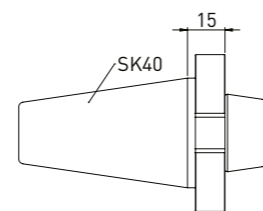

Order No.	Name
350130014	Adapter SK40 on Haas/Walter taper

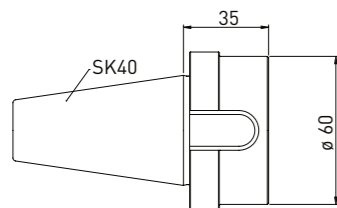

Order No.	Name
350130040	Adapter SK40 on Saacke short taper

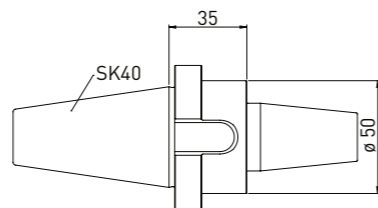

Order No.	Name
350130043	Adapter SK40 on Strausak Fleximat

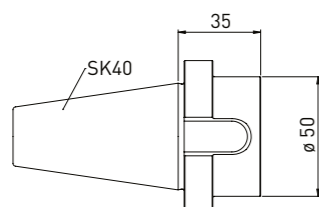

Order No.	Name
350130042	Adapter SK40 on Strausak Promat

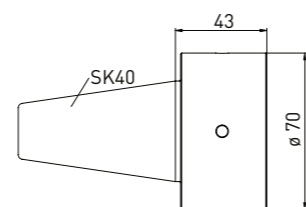

Order No.	Name
350130039	Adapter SK40 on Rollomatic $\varnothing 25$

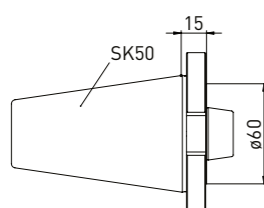

Order No.	Name
350130044	Adapter SK50 on Haas/Walter taper L15

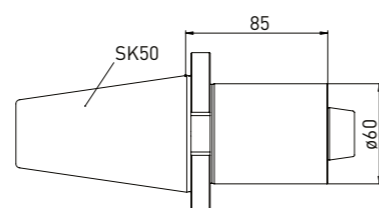

Order No.	Name
350130045	Adapter SK50 on Haas/Walter taper L85

Adapter SK40 on HSK

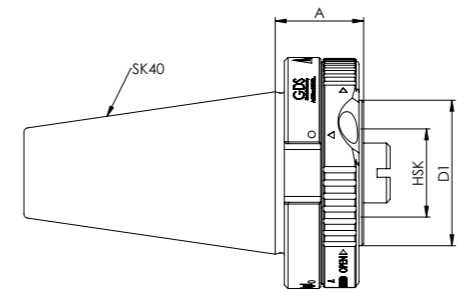

Order No.	A/C/E HSK shape	B/D/F HSK shape	A	D1
350130011	HSK32	HSK40	25	40
350130012	HSK40	HSK50	35	50
350130013	HSK50	HSK63	45	63

Adapter SK50 on HSK

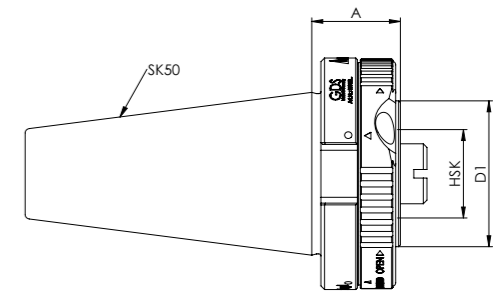

Order No.	A/C/E HSK shape	B/D/F HSK shape	A	D1
350130001	HSK32	HSK40	30	40
350130002	HSK40	HSK50	33	50
350130003	HSK50	HSK63	45	63

Adapters for grinding wheel adapters from $\varnothing 20$ to $\varnothing 10$ // and $\varnothing 20$ to ER16 collet chuck

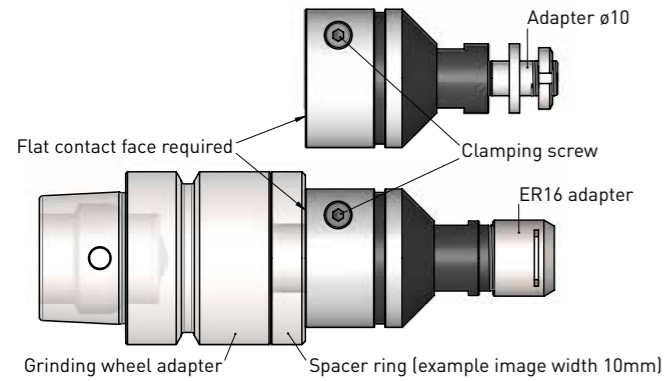

Assembly example

Twist adapter onto M20 x 1 screw and bring to rear to flat contact face.

If needed, lay spacers down first so that the adapter meets the flat contact face.

Subsequently, tighten using spanner flat and secure with clamping screw.

Adapter $\varnothing 20$ on $\varnothing 10$

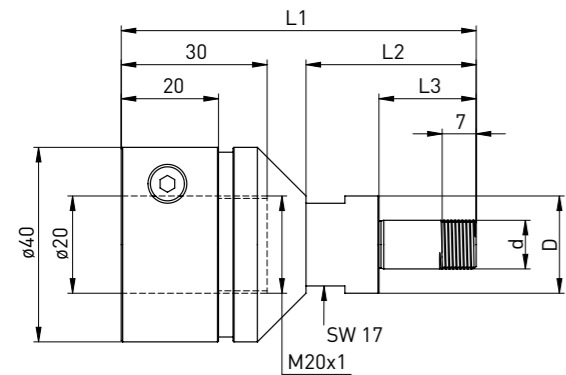

Delivered equipped:
Clamping nut (350020114), Spacer rings 4pc. (350016004)

Order No.	D	d	L1	L2	L3
350130046	20	10	73	35	20

Adapter $\varnothing 20$ on ER16

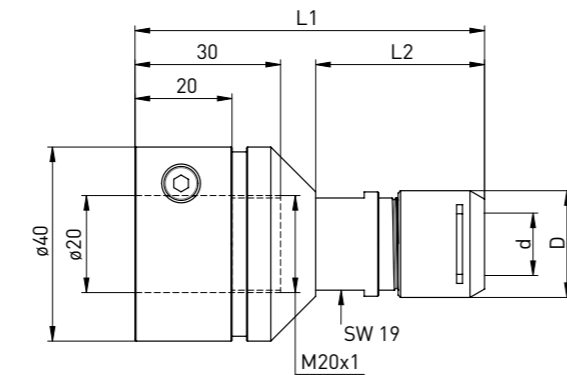

Delivered equipped:
Mini clamping nut Silent ER16 (350020116)

Order No.	D	d	L1	L2
350130047	22	ER16	73	62

Accessories Adapter $\varnothing 20$ on $\varnothing 10$

Order No.	Name - \varnothing
350016004	Spacer ring $\varnothing 20$ x $\varnothing 10$ x 3
350020114	clamping nut $\varnothing 18$ x 4 - M10 x 0,75
350040050	Hook wrench 16-20 mm

Accessories Adapter $\varnothing 20$ on ER16

Order No.	Name
350125116	Mini clamping nut SILENT ER16
350126116	Clamping wrench for Mini clamping nut SILENT ER16

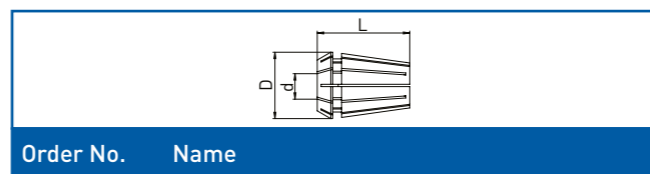

Order No.	Name
3501217**	Collet DIN 6499 ER16 ** \varnothing 1-10mm

**[Please complete the order number with the two-digit number that defines the diameter!] e.g. for $\varnothing 1$ -> last digit 01 (350121701) for $\varnothing 10$ last digit ->10 (350121710)

HSK50 Test and angle dial

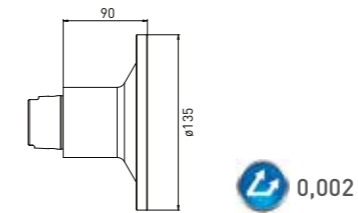

Order No.	Name
350090010	Test and angle dial HSK50

HSK40 Test and angle dial

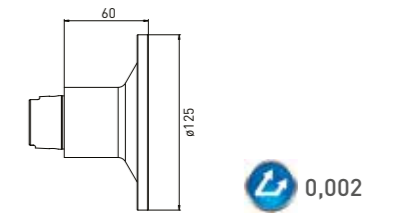

Order No.	Name
350090020	Test and angle dial HSK40

Test and angle dial

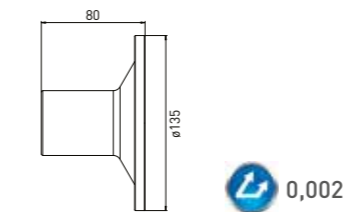

Order No.	Name
350090030	Angle dial Haas/Walter taper 31.75

SK Test mandrel

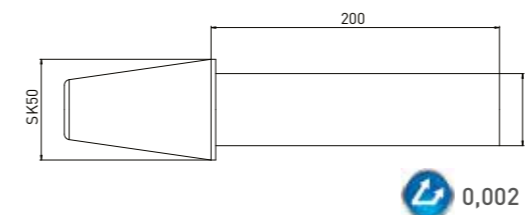

Order No.	Name
350090040	Test mandrel SK50 x $\varnothing 50$ x 200

HSK Test mandrel

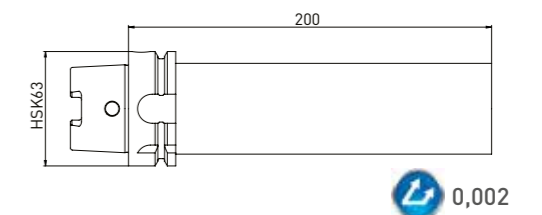

Order No.	Name
350090050	Test mandrel HSK63 x $\varnothing 50$ x 200